



MSI

MANUFACTURING SOLUTIONS, INC.

Phone: 931-762-8773

Fax: 931-766-0083

Email: sales@mfg-sol.com

Website: www.mfg-sol.com

Physical Barrier Fencing

PINNACLE
S Y S T E M S , I N C

Safety Sensors and Controls for Industrial Machine Guarding Systems

www.pinnaclesystems.com

Fencing Overview

The Pinnacle Fencing System is ideal for protecting machinery and plant personnel. The guarding of welding machines, robotics, automated equipment, printing/paper finishing equipment, plastic molding equipment, packaging and wrapping, specialty equipment or any hazardous zone or area is easily accomplished with our fencing system. Our designs are engineered to comply with OSHA and ANSI Standards.

We offer a large selection of wire mesh sizes, customized heights, sweeps, colors and finishes utilizing carbon steel. Stainless steel is also available. Also offered is a full line of hinge and sliding doors to easily integrate into your facility's layout and machine accessibility requirements. We stock a wide variety of safety interlocks if needed for your fencing application. To ease installation, we can pre-drill all holes in the doors, so your safety interlock installation time is minimized.

To round out your **Total Safety Solution**, we manufacture safety light curtains, safety mats and "control reliable" safety controllers which integrate effectively with our fencing system to provide additional guarding and protection. The Pinnacle Fencing System offers protection to keep your workplace and personnel safe and secure.

Features

- Standard size panels – 6'- 2"H (1880 mm) H & 8'-1 ¼" (2480 mm) H.
- Panels install vertically between 6'-6" (1981 mm) H & 8'-5 1/4" (2597 mm) H Posts (4" (102 mm) sweep).
- Custom size panels and special heights available.
- Fully framed panel adds strength and stability unequalled in the industry.
- Hinged and slide doors available in 48 hour quick ship.
- Lift-Out design allows for 75% faster installation.
- One piece of special tool removable hardware meet OSHA & RIA standards: R15.06-1999 (R2009), SS-EN 953, CSA-Z432, CSA-Z434.
- All hardware including anchors included.
- Stock powder coat black panel & yellow post finish.
- Panels may be ordered in alternate woven and welded mesh options, expanded metal, sheet metal, or clear Lexan.
- Lock out plate and pull handle standard all door mounting plates.
- Safety Interlocks available with mounting plates.

Material Specifications

PANELS

Panels are available in standard heights: 6'- 2"H (1880 mm) H & 8'-1 ¼" (2480 mm) H.

DOORS

Hinged or sliding doors are available. Locks and Interlocks are also available.

MESH

Standard 2 ½" x 1 ¼" (63 mm x 32 mm) 10 Gauge Welded Wire. Alternate meshes available depending on your guarding requirements.

FRAMES

1-1/4" x 1-1/4" (32 mm x 32 mm) 13 Gauge angle frame.

FINISH

Available with Powder Coat Finish; black panels, yellow posts.

Mechanical Guarding / Fencing Proposal Request

Please complete the form on the next two pages in order for us to assess your Mechanical Guarding / Fencing needs. An electronic version of this form can also be found on our website at www.pinnaclesystems.com/Proposal-Request.html

Name

Company

Phone Fax

Email

Contact Preference: Email
 Phone
 Fax

1. Please select wire mesh:

- Standard - 2 1/2" x 1 1/4" (63 mm x 32 mm) 10 Gauge Welded Wire
- 2" x 2" (51 mm x 51 mm) Square 6 Gauge Woven Wire
- 2" x 2" (51 mm x 51 mm) Square 10 Gauge Welded Wire
- 1-1/2" x 1-1/2" (38 mm x 38 mm) Square 8 Gauge Woven Wire
- 1-1/2" x 1-1/2" (38 mm x 38 mm) Square 10 Gauge Welded Wire
- 1/2" x 1/2" (13 mm x 13 mm) Square 12 Gauge Woven Wire

2. Please select fencing base material:

- Standard Carbon Steel
- Stainless Steel

3. Select Configuration:

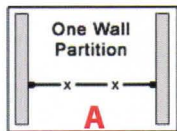

- 1 Wall Partition
(One Sided Partition)

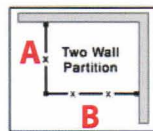

- 2 Wall Partition
(Two Sided Partition)

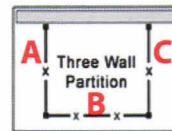

- 3 Wall Partition
(Three Sided Partition)

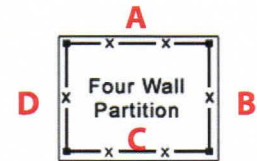

- 4 Wall Partition
(Four Sided Partition)

Configurations more complex than those show above may be sketched and faxed to us at (412) 262-4055 or scanned and emailed to fencing@pinnaclesystems.com.

Length of Wall A: feet inches

- Post at wall-recommended for dry wall/gypsum/metal walls.
- Panels connect directly to masonry or block wall.
- Panels connect directly to wood wall.
- Panels connect directly to dry wall/gypsum/metal walls.

Length of Wall C: feet inches

- Post at wall-recommended for dry wall/gypsum/metal walls.
- Panels connect directly to masonry or block wall.
- Panels connect directly to wood wall.
- Panels connect directly to dry wall/gypsum/metal walls.

Length of Wall B: feet inches

- Post at wall-recommended for dry wall/gypsum/metal walls.
- Panels connect directly to masonry or block wall.
- Panels connect directly to wood wall.
- Panels connect directly to dry wall/gypsum/metal walls.

Length of Wall D: feet inches

- Post at wall-recommended for dry wall/gypsum/metal walls.
- Panels connect directly to masonry or block wall.
- Panels connect directly to wood wall.
- Panels connect directly to dry wall/gypsum/metal walls.



5. Does your fencing require a ceiling? Yes No

6. Height Desired for fencing:

- 6'-6" (1981 mm) (would include a 4 inch (102 mm) sweep)
- 8'-5 1/4" (2597 mm) (would include a 4 inch (102 mm) sweep)
- Custom Dimensions (list dimensions in box below)

7. Sweep Space: (if different than 4 inches (102 mm)) 6 inch (152 mm) 10 inch (254 mm) Other

Sweep Space is the distance from the floor to the bottom of the fence.

8 inch (203 mm) 12 inch (144 mm)

8. Desired Coating:

- Yellow Powder Coated Posts and Black Powder Coated Panels (Standard)
- Powder Orange Powder Blue Other
- Powder White
- Powder Tan Match RAL (color
- Powder Red matching system in Europe) or paint chip

Specify Post Color:

Specify Panel Color:

9. Do you want a door(s)?: Yes. If "Yes" Specify: Hinged Doors Sliding Doors

No

10. Do you want the door to have Safety Interlock Switches? (available with mounting plates): Yes No

11. Do you need installation service?: Yes No

12. What Zip Code will this material be shipped to?:

13. Does your application require additional Safety Solutions? Please check all that apply.

- Safety Light Curtains Ergonomic Palm Buttons Stack Lights
- Safety Mat Systems Safety HUB / Safety PLC's E-Stops
- Punch Press Guards & Controls Press Brake Guards & Controls Resolver or Rotary Cam Based Controls

Additional Information:

For an additional door on a wall, special locks or other important information regarding your layout, please list below:

